

# A Caravan for The Brambles



# Contents

**Meet The Brambles**

**Caravanning the Bramble Way**

**The Ideal Van**

**The Design**

**Concept**

**Plans**

**Interior**

**Materials**

**Exterior**

Our Caravan – Aged 10  
Loves Weekends

Iain – Aged 34  
Loves Hazelnut  
Yoghurt

Ellie - Aged 5  
Loves Pink

Julia – Aged 33  
Loves Lindor  
Chocolate

Alex - Aged 3  
Loves Lego

# The Brambles

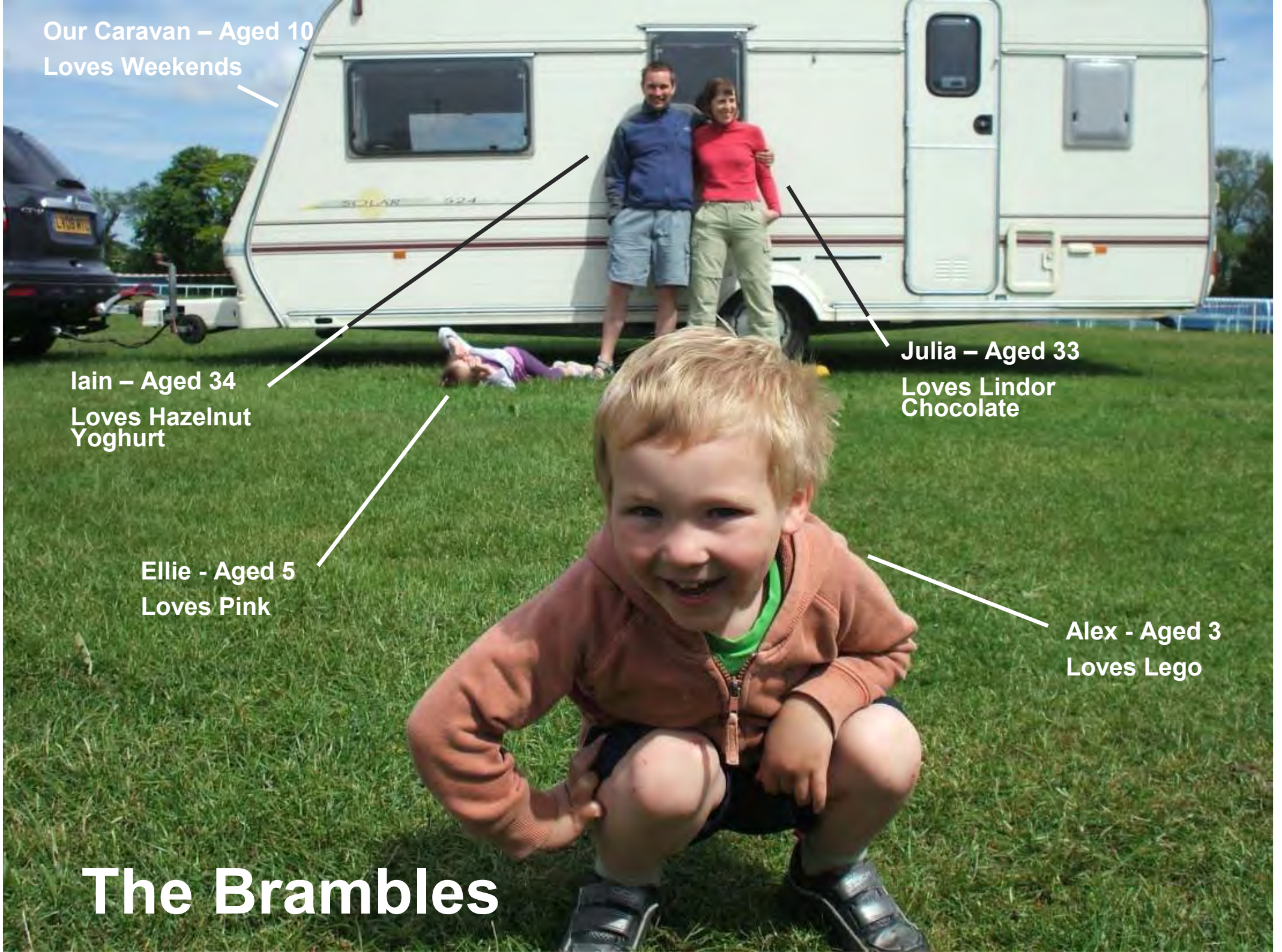

**Caravanning to us is all about getting away. Away to a place special to us. A family space where we can spend time together. Away from our busy day to day lives. A place to relax. A place of our own. A home from home.**

**Caravanning the Bramble Way**

**The ideal caravan for a young family is: Maximum living space, Maximum privacy, Dedicated sleeping areas, Easy access to facilities, Hardwearing, Practical and Durable**



**The Ideal Caravan**



# A Caravan for The Brambles The Design

Our Awning – Age Unknown  
(Rescued from EBay)  
Loves the Sun, Leaks in the Rain



A family caravan should provide as much space as necessary, as much privacy as necessary, be comfortable, welcoming and manageable.

It needs to function in all situations, allowing for overnight stops, long weekends or extended holidays.

A family caravan needs adapt to the ever changing family dynamic. A caravan will outlast a child's tantrum, it will outlast a mood or difficult phase. A family caravan needs to accommodate the unexpected, allowing the family to relax.

## Concept

With young children we can live on top of each other. We can live with a lack of privacy. However as the children grow the caravan will need to adapt. It is obvious that space will be a premium, space to share, space to be alone. Understanding the challenges ahead has lead to our design.

## Family friendly caravan brainstorm

Distinct sleeping areas – appeal to families with children of all ages  
Sleeping area for families with younger children as four berths with no top bunk would be ideal

“child” sleeping area at end of caravan – away from traffic area near door and bathroom

Maximum living space – no fixed bed

Designed for use with and without awning

External storage designed for use with awning

Awning pole storage

End bathroom with separate shower – sites with no facilities

Functional living spaces

Clever storage

shoe racks near door

Self Sufficient

240V solar panel on roof to allow use on holiday meets and no facility sites

Energy Efficient

LED lighting

Maximise use of natural light

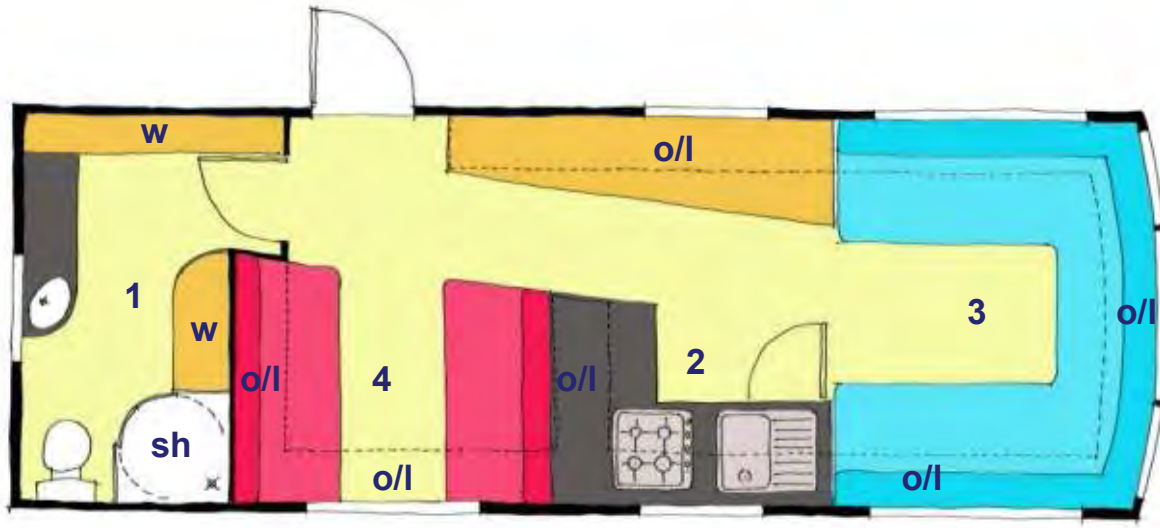

Day

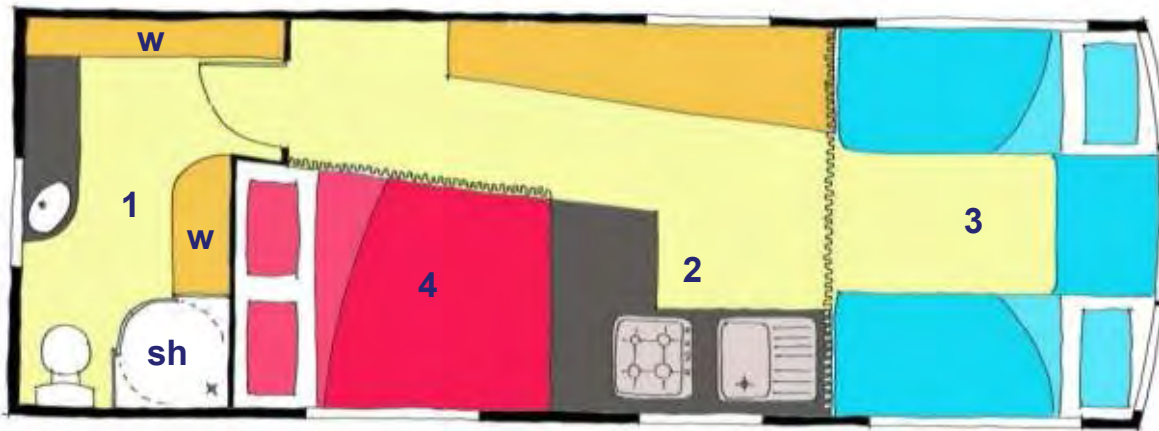

Night

Layouts based upon Bailey Senator Wyoming floor plate

## Daytime

### 1 Washroom

Thetford electronic flush WC  
Shower cubicle  
wash hand basin with domestic style mixer taps  
Large counter top for family cosmetics  
Family wardrobe and clothes storage

### 2 Kitchen

4 ring hob – 1 electric to save on gas usage  
Gas oven  
Integrated high level microwave  
Slim Line Extractor fan  
Fridge Freezer  
Sink with Chopping board cover to maximise preparation space  
Separate draining board which can be stowed away when not in use

### 3 Main Living

Ample seating for whole family  
Main internal seating areas during the day  
Integrated TV/DVD system with earphone jacks and gaming sockets  
Integrated DAB Radio with AUX jack for MP3 players  
Clear rooflight above to allow natural light

### 4 Snug

Cosy seating area ideal for use once children asleep  
Shoe storage under seat adjacent to entrance door  
Integrated TV/DVD system with earphone jacks and gaming sockets  
Integrated DAB Radio with AUX jack for MP3 players  
Clear rooflight above to allow natural light

## Nighttime

### 1 Washroom

### 3 Children's sleeping area

w wardrobe

o/l  
overhead  
locker

### 2 Kitchen

### 4 Parents sleeping area

sh shower

## Interior

Internal arrangement divides the space efficiently to allow simultaneous activities to take place, both during the day and evening.

The distinct living / sleeping areas provide the degree of privacy to allow a growing family to mature. The use of the kitchen and the purposeful angled storage to define these spaces allows the caravan to function at several levels.

All can access the kitchen, washroom or exit the caravan without disturbing others. This level of access within the caravan assists in creating a calm, relaxing environment in which all can unwind and enjoy time together.

Technology aids the process with dedicated headphone and games console points to the integrated TV, allowing quiet play to be undertaken without disturbing the other family members

Discrete, accessible shoe storage at the ends of the snug seating adjacent to the main door allow all shoes to be tidied away, particularly when there is no awning to assist.

w wardrobe

o/l overhead locker

u/l underbench locker

s/r shoe rack

Interior elevation

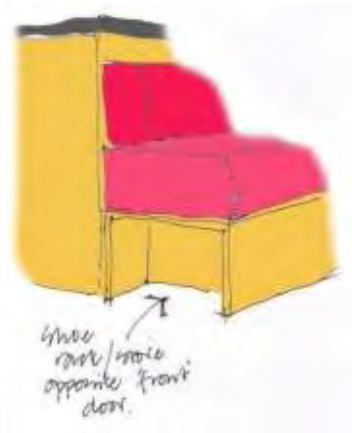
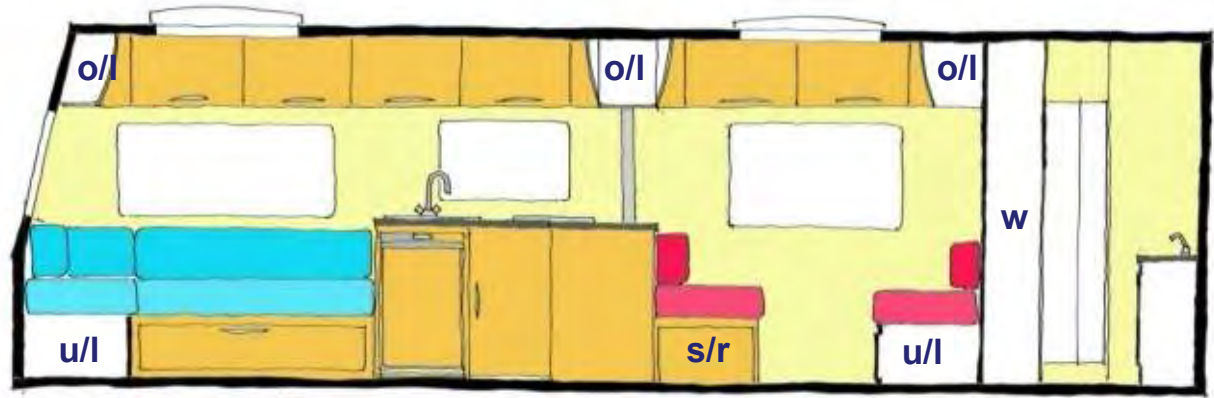

Model images

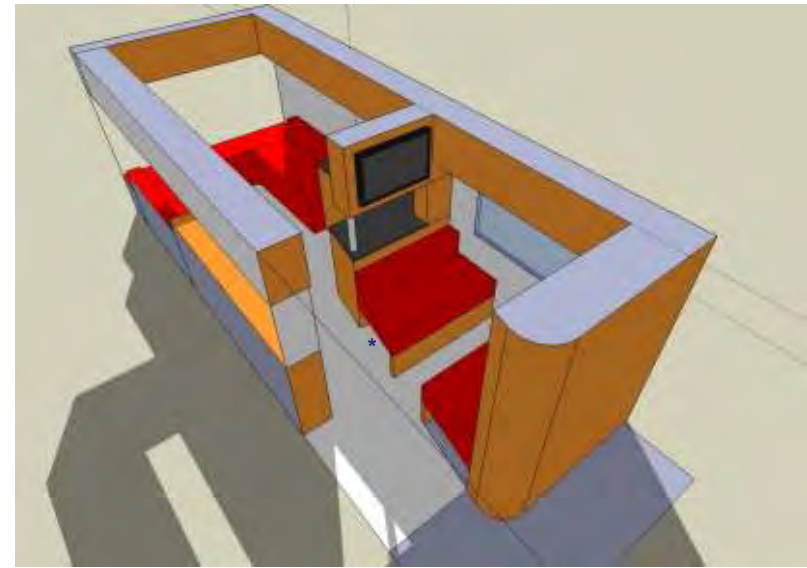

\* s/r shoe rack

## **Materials**

**Contemporary fabrics, laminates, natural rubber and carpets provide a degree of sophistication. Creating a true home from home, a place to relax and unwind, whilst requiring minimal maintenance .**

### **Robust materials**

**High gloss, scratch resistant laminates on cupboard fronts**

**Natural rubber flooring in kitchen, entrance and washroom allow ease of cleaning when wet**

**Carpet to seating areas provide warmth and comfort**

**'Scotch Guarded' fabrics on sofas.  
Striped pattern for modern fresh look  
Textured fabric curtains to coordinate with main sofa fabric.**

Natural rubber



Textured curtains

Bold sofa fabric

## Exterior

### Safety

High Visibility Markings to rear corners to improve visibility day and night on road

Richer body colour for improved visibility and aesthetic.

### Awning functionality

240V socket to awning to allow use of electrical equipment  
Clever storage accessed from awning, ability to store food stuffs for use within awning. Doors to drop and for table/bench units

Gas connections for barbeque to each side to counteract prevailing winds.

Full length LED awning light to illuminate awning roof.  
Awning roof effectively becomes the light source at night.

### Use on the move

Awning pole storage accessed externally. No need for awning poles within unit duration transit

Snug seating area accessible for stops during transit.

## Rear elevation

with LED awning light illuminating  
awning roof \*

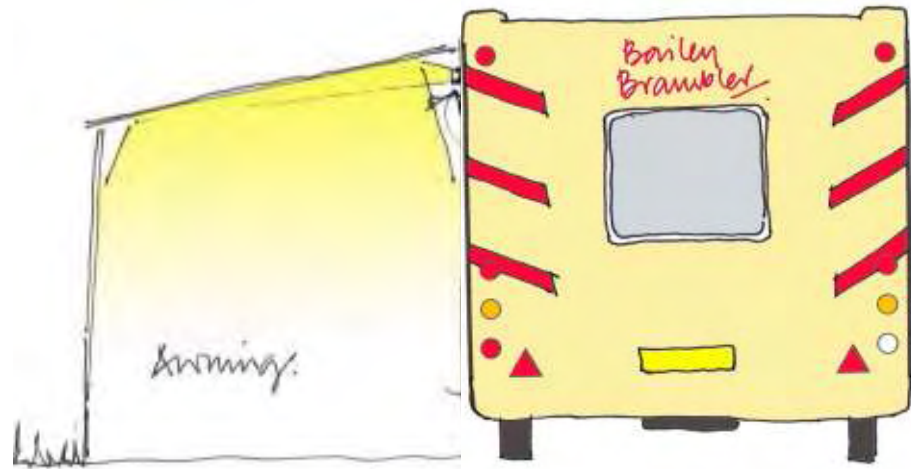

## Side elevation

